

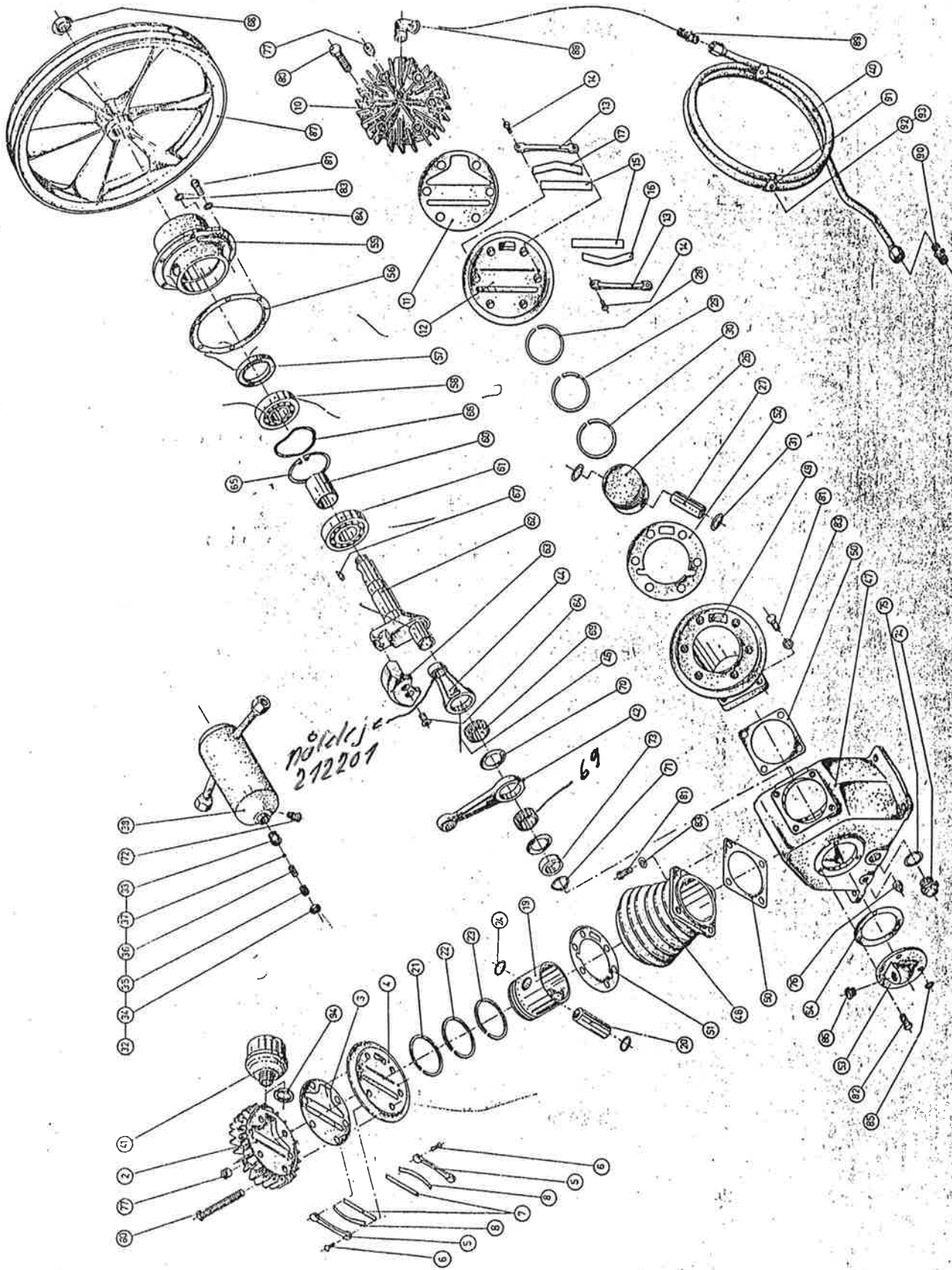

KOMPRESSORBLOK
COMPRESSOR BLOCK

Før 77

K 13A
K 13B
K 13C



*note
212201*

69

Pos. nr. Item No.	Antal Quantity	BETEGNELSE	Best. nr. Part No.	DESCRIPTION	Pris Price
		Kompressorblok, komplet K 13 A K 13 B K 13 C	003018 003015 003016	Compressor block, complete K 13 A K 13 B K 13 C	
1	1	Topstykke og melleplade, komplet lavtryk, bestående af pos. 2-8	643010	Cylinder head and intermed. plate complete, low-pressure, consisting of items 2-8	
2	1	Topstykke	341021	Cylinder head	
3	1	Pakning f. topstykke	355011	Packing for cylinder head	
4	1	Melleplade	342091	Intermediate plate	
5	2	Ventilstyr	343031	Valve guide	
6	4	Skrue, unders., 5 MG x 20	254642	Screw, countersunk, 5 M x 20	
7	2	Ventilbånd	343181	Valve strip	
8	2	Fjederbånd	343210	Spring leaf	
9	1	Topstykke og melleplade, komplet højtryk, bestående af pos. 10-17	643020	Cylinder head and intermed. plate complete, high-pressure, consisting of items 10-17	
10	1	Topstykke	341380	Cylinder head	
11	1	Pakning f. topstykke	355101	Packing for cylinder head	
12	1	Melleplade	342190	Intermediate plate	
13	2	Ventilstyr	343031	Valve guide	
14	4	Skrue, unders., 5 MG x 20	254642	Screw, countersunk, 5 M x 20	
15	2	Ventilbånd	343200	Valve strip	
16	1	Fjederbånd, ind sugning	343280	Spring leaf, suction	
17	1	Fjederbånd, trykventil	343280	Spring leaf, pressure valve	
18	1	Stempel, komplet LT, bestående af pos. 19-24	645050	Piston, complete, LP, consisting of items 19-24	
19	1	Stempel	345622	Piston	
20	1	Stempelpind	345190	Piston pin	
21	1	Stempelring	345210	Piston ring	
22	1	Skraberings	345610	Scraper ring	
23	1	Ollering	345220	Oil scraper ring	
24	2	Låsering	211722	Lock ring	
25	1	Stempel, komplet HT, bestående af pos. 26-31	645020	Piston, complete, HP, consisting of items 26-31	
26	1	Stempel	345631	Piston	
27	1	Stempelpind	345640	Piston pin	
28	2	Stempelring	345040	Piston ring	
29	1	Skraberings	345051	Scraper ring	
30	1	Ollering	345150	Oil scraper ring	
31	2	Låsering	211719	Lock ring	
32	1	Sikkerhedsventil, bestående af pos. 33-37	702450	Safety valve consisting of items 33-37	
33	1	Hus	302130	Casing	
34	1	Kontramgtrik	302140	Lock nut	
35	1	Justerskrue	302160	Adjusting-screw	
36	1	Fjeder	317210	Spring	
37	1	Kugle, 6 mm	211807	Ball 6 mm	
38	1	Mellemkøler	651030	Intercooler	
39	1	Bagkompressionsrør	654050	Return compression pipe	
40	1	Kølespiral, komplet	654660	Cooling-coil, complete	
41	1	Indsugningsfilter	656380	Suction filter	
42	1	Plejlstang, komplet LT	646810	Connecting rod, complete, LP	
44	1	Plejlstang, komplet HT, bestående af pos. 45-46	646860	Connecting rod, complete, HP, consisting of items 45-46	
45	1	Nåleleje, NA 12 f. HT plejlstang	212201	Needle bearing, NA 12 for HP conn. rod	
46	1	Ollespisker f. HT plejlstang	211148	Oil thrower for HP connecting rod	
47	1	Krumtaphus	350502	Crank case	
48	1	Cylinder, LT	344200	Cylinder, LP	
49	1	Cylinder, HT	344200	Cylinder, HP	
50	2	Pakning for cylinder	355111	Packing for cylinder	
51	1	Pakning for LT melleplade	355022	Packing for LP intermed. plate	
52	1	Pakning for HT melleplade	355112	Packing for HP intermed. plate	
53	1	Inspektionsdæksel	349361	Inspection cover	
54	1	Pakning for inspektionsdæksel	355090	Packing for inspection cover	
55	1	Lejehus	349282	Bearing casing	
56	1	Pakning for lejehus	355590	Packing for bearing casing	
57	1	Olietætningsring, 6080	213028	Oil sealing ring, 6080	
58	1	Kugleleje, 6308	212065	Ball bearing, 6308	
60	1	Afstandsbsning, lang	318240	Distance bushing, long	
61	1	Kugleleje, 6309	212068	Ball bearing, 6309	
62	1	Krumtap	347931	Crank	
63	1	Kontravægt	347870	Counter weight	
64	2	Skrue unders. roulet hoved, 10 MG x 25, DIN 7991	357000	Screw, countersunk, knurled head, 10 M x 25 DIN 7991	
65	1	Seegerring 190 x 300, DIN 472	211751	Seeger ring 190 x 300 DIN 472	
66	1	Fjederring #89/79 for kugleleje	212003	Circlip #89/79 for ball bearing	
67	1	Skilvfjeder 13 x 8, DIN 6888	211004	Woodruff key 13 x 8 DIN 6888	
68	1	Rismøtrik, afdr. 1" RG	240181	Pipe nut, bright, 1" BSP	
69	2	Inderring, IR 35 x 42 x 20	212202	Inner ring, IR 35 x 42 x 20	
70	3	Nålekrans, K 42 x 50 x 20	212203	Needle ring, K 42 x 50 x 20	
71	1	Afstandsring, #60 x 35 x 2	318350	Distance ring, #60 x 35 x 2	
72	1	Sikringsring, 35 U	211735	Retaining ring, 35 U	
73	1	Luftskyrue, 1/8" RG	214310	Water drain screw, 1/8" BSP	
74	1	Afstandsbsning	318090	Distance bushing	
75	1	Ollerglas, 1" RG, komplet m. pakning	639700	Oil sight glass, 1" BSP, complete with packing	
76	1	Pakning for ollerglas, alene	355580	Packing for oil glass only	
77	2	Olleraftapningsprop, 1/2" RG	216521	Oil drain plug, 1/2" BSP	
78	1	Rørprop, DIN 906 3/8" RG	216537	Pipe plug, DIN 906 3/8" BSP	
79	2	Vinkel for mellemkøler, 3/4" RG x 19 rør	220555	Elbow for intercooler, 3/4" BSP x 19 pipe	
80	10	Skrue for topstykke, 6 kt. 3/8" WG x 80 8 G, DIN 931	243031	Screw for cylinder head, hexag. 3/8" W x 80 8 G, DIN 931	
81	14	Skrue for cylinder og lejedæksel 3/8" WG x 25, 6 kt. kvalitæt 8 G, DIN 931	243026	Screw for cylinder and bearing cover, 3/8" W x 25 hexag. quality 8 G, DIN 931	
82	3	Skrue for insp. dæksel, 6 kt. 5/16" WG x 20 4 D, DIN 558	241412	Screw for inspection cover, hexag. 5/16" W x 20 4 D, DIN 558	
83	9	Kobberskive, #14/10 x 1	212740	Copper washer, #14/10 x 1	
84	5	Fjederskive, 3/8"	214805	Spring collar, 3/8"	
85	1	Kobberskive, #13/8 x 1	212739	Copper washer, #13/8 x 1	
86	1	Bagkompressionsventil 1/2" RG	602320	Return compression valve, 1/2" BSP	
87	1	Swinghjul, 2 A-490	217357	Flywheel, 2 A-490	
88	1	Vinkel for kølespiral, 1/2" RG, GF 92	327480	Elbow for cooling-coil, 1/2" BSP, GF 92	
89	1	Nippel 1/2" RG x 16 rør	327480	Nipple, 1/2" BSP x 16 pipe	
90	1	Nippel f. afg., 3/4" RG x 16	327740	Nipple for outlet, 3/4" BSP x 16	
91	4	Spændestykke f. kølespiral	340700	Clamp for cooling-coil	
92	2	Bolt M 8 WG x 35, DIN 601	241113	Bolt M 8 W x 35, DIN 601	
93	2	Fjederskive 5/16" DIN 127	214804	Spring collar 5/16", DIN 127	
94	1	Gummiring, #37/28 x 4	213216	Rubber ring #37/28 x 4	
		Reservedelssæt bestående af pos. 3-7-8-11-15-16-17-21-22-23-28-29-30-50-51-52	759550	Spare Parts Kit consisting of items 3-7-8-11-15-16-17-21-22-23-28-29-30-50-51-52	
		Stempelsæt, LT	759800	Piston replacement kit, LP	
		Stempelsæt, HT	759850	Piston replacement kit, HP	
		Stempelringsæt, LT	759300	Piston ring kit, LP	
		Stempelringsæt, HT	759350	Piston ring kit, HP	
		Ventilrenoveringssæt, LT	759200	Valve repair kit, LP	
		Ventilrenoveringssæt, HT	759210	Valve repair kit, HP	

RG = Pipe Thread MG = Metric Thread WG = Whitworth Thread LP = Low Pressure HP = High Pressure