 <b>DANFOSS SYSTEM HYDRAULIK A/S</b>		PARTS-, SPARE PARTS, & MATERIAL LIST			
		COMPONENT: TYPE & VERSION	SHEET: 1	OF: 2	
		KFCM 52 - A1	160B0340	ISSUE	
			PSM.NO 052P038	×	
Notes: All items with stated ID nos. can be purchased as spare parts. When ordering spare parts – state ID no.			DATE	BY	CHECK
DRAWINGS REFERRED TO:					
DRAWING NO.	REF.	DESCRIPTION			
052B4811	a	Assembly drawing			
	b				
	c		921021	LSI	
	d		860902	LSI	OPE 1

ITEM Nos. or capital letters	REF.	ID NO.	PARTS DESCRIPTION	QTY	MATERIAL	CTM NO.
1	a		Housing	1	GGG 40	A10
2	a		Piston	1	GGG 40	A10
3	a		Spindle	1	S-1802	F10
4	a		Top part	1	SKF280	B54
5	a		Spring guide	1	MS 58	L05
6	a		Spindle f. man. operation	1	MS 58	L05
7	a		Retainer	1	MS 58	L05
8	a		Bushing	1	MS 58	L05
9	a		Stop bush	1	MS 58	L05
10	a	045E4381	Clamping ring	1	S-1802	F10
11	a	044-4561	Release lever unit	1		
			Compression spring	1	St. 60	
			Spring holder	1	Esm. B	L50
			Locking ring	1	MS 58	L05
			Pointed screw M4 x 4 DIN 916	1	70/A2	7A2
			Crosshead DIN 6335	1	EL-Zn+	
13	a	036E0811	Hand lever shaft	2	AISI 304	F05
14	a	036E0821	Extension shaft	2	Esm. B	L50
16	a	033E6181	Screw-plug 3/8"RG	2	9SMnPb28	B10
17	a		O-ring 119.3 x 5.7	1	NBR 70	NBR
18	a					
19	a		O-ring 44.5 x 3.0	1	NBR 70	NBR
20	a		O-ring 41.5 x 3.0	1	NBR 70	NBR
21	a		O-ring 34.5 x 3.0	3	NBR 70	NBR
22	a		Scraper $\phi 60/\phi 70-7/10$	1	NBR 90	
23	a		Scraper $\phi 35/\phi 43-7/4$	1	NBR 90	
24	a	231-1022	Disc spring 125/61 x 6.0	23	50CrV4	N15
25	a		Thrust washer $\phi 60/\phi 75$ x 3.0	1	C-75	



**DANFOSS  
SYSTEM  
HYDRAULIK A/S**

**PARTS-, SPARE PARTS, & MATERIAL LIST**

COMPONENT: TYPE & VERSION

KFCM 52 - A1

SHEET: 2 OF: 2

160B0340

PSM.NO 052P0381

ITEM Nos. or capital letters	REF.	ID NO.	PARTS DESCRIPTION	QTY	MATERIAL	CTM NO.	CTM no. refers to DSH sheets: COMPARISON TABLES for MATERIALS
26	a	390-0205	Thrust washer $\phi$ 25	2	St.3	POL	
27	a	390-0005	Thrust needle bearing $\phi$ 25	2	100Cr6	ROL	
28	a	390-0105	Thrust disc $\phi$ 25	2	St.3	POL	
29	a		Pin $\phi$ 12 x 110 DIN 7	1	St.50K		
30	a		Cyl. roller $\phi$ 6 x 12	1	100Cr6	ROL	
31	a	234-2035	Top cap $\phi$ 75 x $\phi$ 39	1	PVC		
32	a	234-0850	Knob f. handle $\phi$ 50 x $\phi$ 20	2	Phenol		
34	a	250-2136	Screw M12 x 40, 6K DIN 933	16	8.8	08.8	
35	a	251-1105	Screw M 8 x 25 C-I6K DIN 912	2	70/A2	7A2	
36	a		Pointed screw M8 x 25 DIN 915	1	14.9	14.9	
37	a		Pointed screw M6 x 16 DIN 916	3	70/A2	7A2	
39	a		Nut M24 DIN 934	1	50/A2	5A2	
40	a	208-0053	Washer $\phi$ 17/ $\phi$ 22 x 1.5	2	Copper DLP	L02	
41	a		Name plate 74 x 51 x 0.5	1	Stainless	F90	
42	a		Pin $\phi$ 1.9 x 5	4	50/A2	5A2	
43	a		X-ring 59.69/70.35 x 5.33	1	NBR 85	PD	
44	a		O-ring 24.5 x 3.0	1	NBR 70	NBR	
45	a		Cable ties 5 x 360	1	Nylon 6.6		
46	a	023-6771	Air escape valve	1			
			Housing	1	MS 58	L05	
			Cone spindle	1	MS 58	L05	
			Compression spring	1	St.60		
			Disc $\phi$ 5.3 DIN 125	1	Steel		
			O-ring 5.1 x 1.6	1	NBR 70	NBR	
			Pin 1.5 x 15	1	Copper DLP	L02	
47	a	208-0053	Washer $\phi$ 17/ $\phi$ 22 x 1.5	1	Copper DLP	L02	
48	a		O-ring 37.5 x 3.0	1	NBR 70	NBR	
49	a		O-ring 126.72 x 1.78	1	NBR 70	NBR	
		219-0178	<u>Seal kit KFCM 52</u>				
			Consisting of:				
			Item 17-19-20-21-				
			22-23-43-44-48-49.				

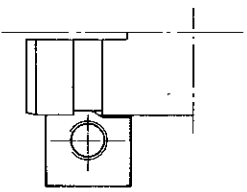
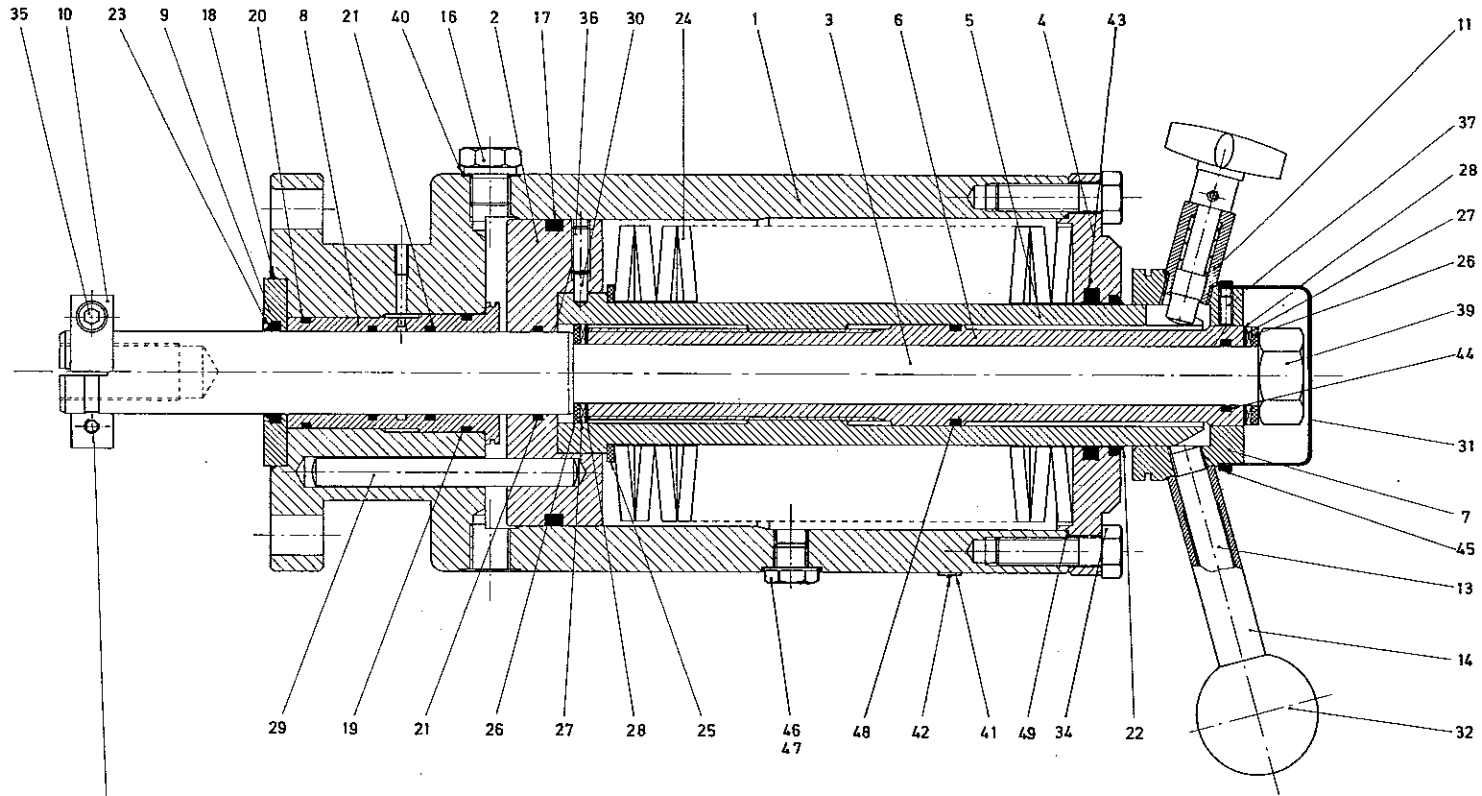

21

N		KFCM		A1/ 1052B4811							
<p>REVISIONS</p> <table border="1"> <tr> <th>NO.</th> <th>DATE</th> <th>DESCRIPTION</th> </tr> <tr> <td> </td> <td> </td> <td> </td> </tr> </table>						NO.	DATE	DESCRIPTION			
NO.	DATE	DESCRIPTION									
<p>APPROVED</p> <table border="1"> <tr> <td> </td> <td> </td> <td> </td> <td> </td> <td> </td> <td> </td> </tr> </table>											
<p>DATE: 12/12/01</p>											
<p>PROJECT: DANFORS SYSTEM HYDRAULIKAS</p>											
<p>ASSEMBLY DRAWING</p>											
<p>KFCM</p>											