 DANFOSS SYSTEM HYDRAULIK A/S		PARTS-, SPARE PARTS, & MATERIAL LIST			
		COMPONENT: TYPE & VERSION		SHEET: 1 OF: 2	
Notes: All items with stated ID nos. can be purchased as spare parts. When ordering spare parts – state ID no.		BRCF 024 - B1		PSM NO. 160N4036	
				ISSUE ×	
		DATE	BY	CHECK	↓
DRAWINGS REFERRED TO:					
DRAWING NO.	REF.	DESCRIPTION			
160N9219	a	Assembly Drawing			
	b				
	c				
	d	940530	LSI		

ITEM Nos. or capital letters	REF.	ID NO.	PARTS DESCRIPTION	QTY.	MATERIAL	CTM NO.
01	a		Housing	1	GGG 40	A10
02	a	160N4315	Top cover	1	GGG 40	A10
03	a	160N4320	Piston	1	GGG 40	A10
04	a		Splined member	1	GGG 40	A10
05	a	160N4349	Output shaft	1	SKF 280	B58
06	a	160N4350	Bottom member	1	GGG 40	A10
07	a	034E2621	Clutch member	1	GGG 40	A10
08	a	160N4310	Indicator shaft	1	S-1802	F10
09	a	034E2641	Disc	1	9SMnPB28	B50
10	a	160N4337	Top cover	1	MS 58	L05
11						
12	a	023-6771	Breather valve	1	MS 58	L05
13	a		O-ring 104.14x5.33	1	Buta	PD
14	a		X-ring 75,57x5,33	1	Buta	PD
15	a		X-ring 17,75x2,62	1	Buta	PD
16	a		X-ring 17,75x2,62	1	Buta	PD
17	a		O-ring 119,50x3,0	1	Buta	NBR
18	a		O-ring 114,50x3,0	1	Buta	NBR
19	a		Gasket	1	Chloropr.	
20	a		X-ring 17,75x2,62	1	Buta	PD
21	a	390-0015	Thrust bearing ø75	1	St-3	POL
22	a	390-0115	Thrust disc ø75	2	100Cr6	ROL
23	a	258-9141	Guide ring ø63/ø80x3,0	2	C75	Y03
24	a	231-1025	Disc spring 125/64x6,0 (5,70)	28	50CrV4	N15
25	a	250-0128	Screw M12x50 6K DIN 931	11	A4/80	8A4
26	a	251-0130	Screw M10x25	4	8.8	08.8
27	a	251-1054	Screw M5x12 DIN 912	3	A2/70	7A2
28	a	251-7136	Pin screw M10x40 DIN 916	8	A2/70	7A2

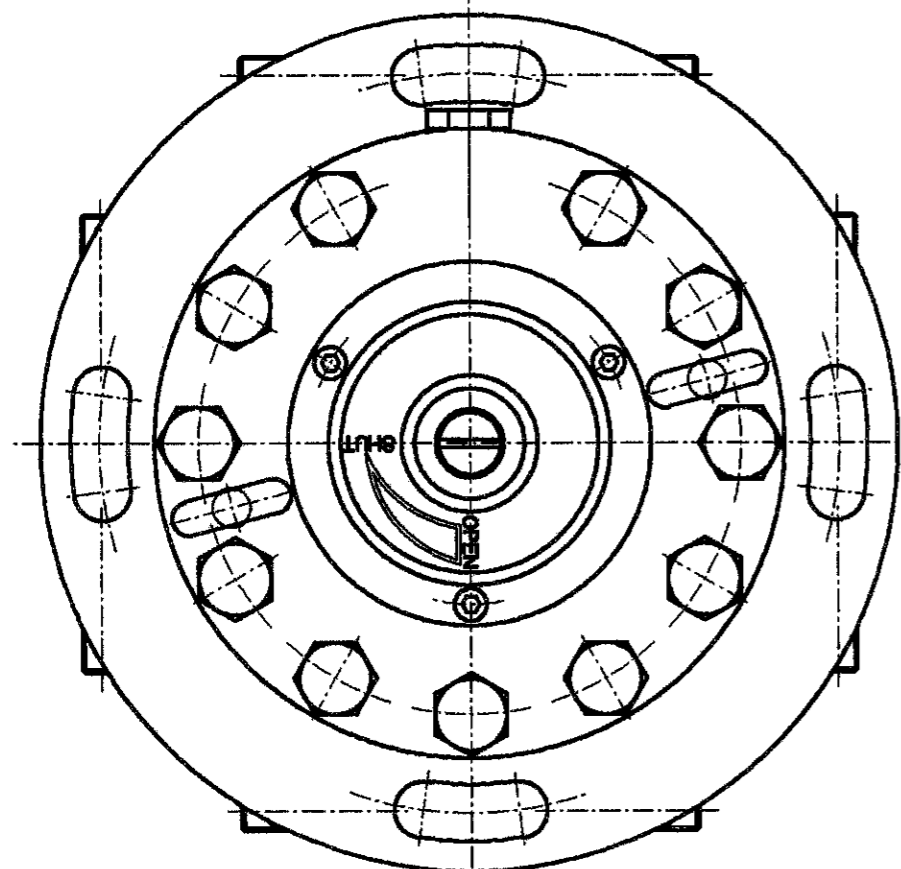

PARTS- SPARE PARTS & MATERIAL LIST	
COMPONENT: TYPE & VERSION	SHEET: 2 OF: 2
BRCF 024 - B1	
	PSM NO. 160N4036

ITEM Nos. of Capital Items	REF	ID: NO	PARTS DESCRIPTION	QTY	MATERIAL	CTM NO.	CTM no. refers to DSH sheets: COMPARISON TABLES for MATERIALS	
29	a	266-0007	Locking disc M10 DIN 6798	8	C15			
30								
31	a		Name plate	1	Stainless	F90		
32	a	260-0412	Pin ϕ 1,9x5	4	Stainless	8A4		
33								
34								
35	a		Glydring ϕ 120/ ϕ 104,5x6,3	1	Turcite 46	PF3		
36	a		Heli-coil M10 (1.5)	4	X5CrNi18 10			
37	a	250-2341	Screw M10 x 90 DIN 933	4	08.8	8.8		
38	a		Warning plate 55 x 26 x 1.0	2	Stainless	F90		
39	a		Pin ϕ 1.9 x 5	4	Stainless	8A4		
40	a		Plug G 3/8	1	Steel			
41	a	160N4034	Filter insert	1				
42	a		Eye bolt M10 x 30	2	Steel			
200	a	230-0044	Adhesive open/shut sign plate	1	Stainless	5A2		
		160N4269	<u>Seal set BRCF 024 - B1</u> Consisting of item 13-14- 15-16-17-18-19-20-35-38-39.					



Torque 45 Nm (oiled)

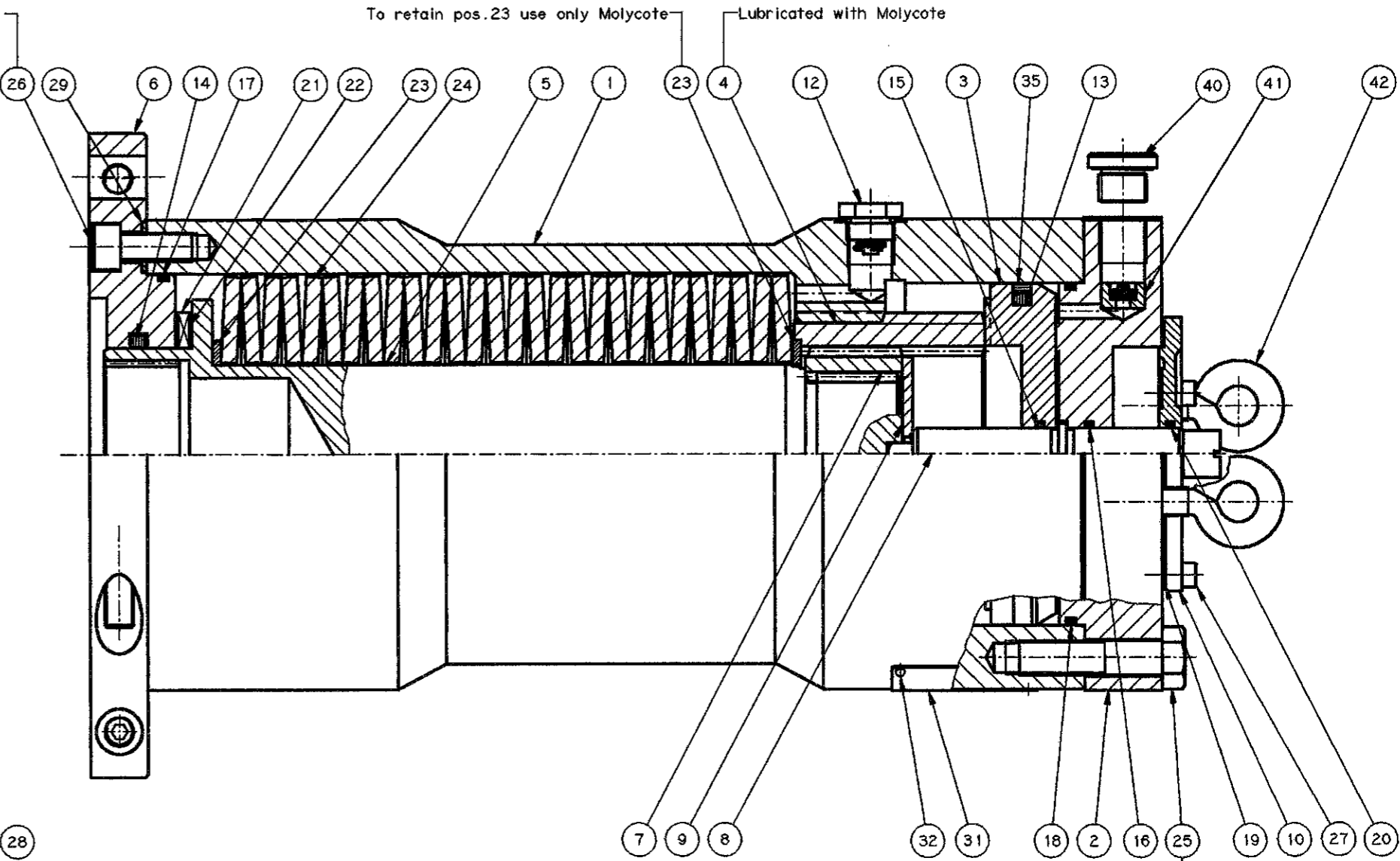
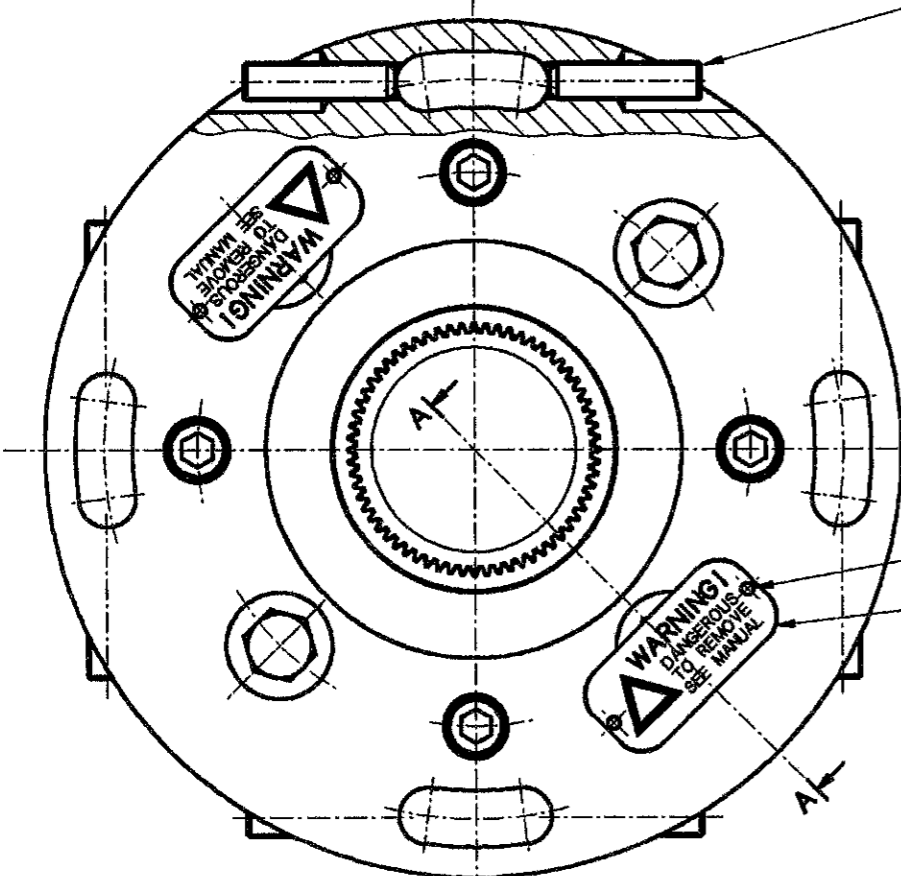

To retain pos.23 use only Molycote

Lubricated with Molycote

Torque 80 Nm (oiled)

A-A

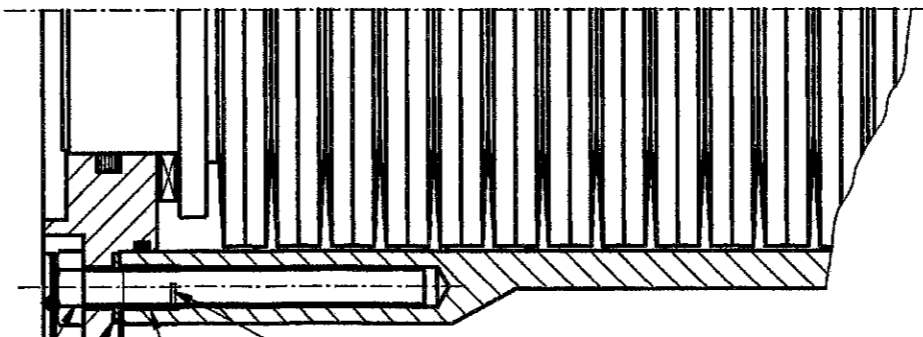

0.4 - 1.1 mm svarende til 1/4-3/4 gevind indenfor endeflade
Tvertap fjernes med sprængdorn

36 Helicoll sikres i hus med Loctite 307. (Affædning, brug af aktivator samt hærde tid fremgår af tekst på flasken).
Loctite påføres husets gevind som følger:
En stribe (ca. en dråbe) i gevindets længde.
En stribe rundt i yderste gevind.

Torque 45 Nm (oiled)

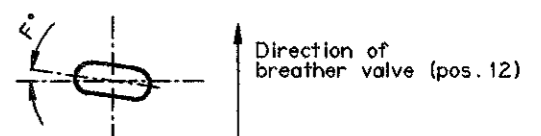

For establishing correct position of indicator shaft (pos.8) do as follows:
The spline shaft (pos.5) is to be mounted as shown with the long hole in angle $F=8.0^\circ$.
If possible use special tool shown on draw. SK-1739.

Before mounting of piston (pos.3) approx. 0.45 liter gear oil must be poured over splined member (pos.4)

N		ASSEMBLY DRW.		BRCF 024		160N9219	
1:1		O		940517 JSJ JSJ		KG	
DANFOSS		HYDRAULIK A/F		ASSEMBLY DRW.		BRCF 024	