 DANFOSS SYSTEM HYDRAULIK A/S	PARTS-, SPARE PARTS, & MATERIAL LIST				
	COMPONENT: TYPE & VERSION		SHEET: 1	OF: 2	
	BRCF 012 - B1		PSM NO. 160N4008		
Notes: All items with stated ID nos. can be purchased as spare parts. When ordering spare parts – state ID no.		DATE	BY	CHECK	↓
DRAWINGS REFERRED TO:					
DRAWING NO.	REF.	DESCRIPTION			
160N9201	a	Assembly Drawing			
	b				
	c				
	d	900601	SV		

ITEM Nos. or capital letters	REF.	ID NO.	PARTS DESCRIPTION	QTY	MATERIAL	CTM NO.
01	a		Housing	1	GGG 40	A10
02	a	160N4314	Top cover	1	GGG 40	A10
03	a	160N4319	Piston	1	GGG 40	A10
04	a		Splined member	1	GGG 40	A10
05	a	034D0881	Output shaft	1	SKF 280	B58
06	a	034C0891	Bottom member	1	GGG 40	A10
07	a	034E0901	Clutch member	1	GGG 40	A10
08	a	160N4309	Indicator shaft	1	S-1802	F10
09	a	034E0921	Disc	1	9SMnPB28	B50
10	a	051E6521	Top cover	1	MS 58	L05
11						
12	a	023-6771	Breather valve	1	MS 58	L05
13	a		O-ring 85,09x5,33	1	Buta	NBR
14	a		X-ring 54,50/ 65,16x5,33	1	Buta	PD
15	a		X-ring 17,75/ 22,99x2,62	1	Buta	PD
16	a		X-ring 17,75/ 22,99x2,62	1	Buta	PD
17						
18	a		O-ring 94,50x3,0	2	Buta	NBR
19	a		Gasket	1	Chloropr.	
20	a		X-ring 17,75/22,99x2,62	1	Buta	PD
21	a	390-0011	Thrust bearing ø55	1	St-3	POL
22	a	390-0111	Thrust disc ø55	2	100Cr6	ROL
23	a	258-9134	Guide ring ø50/ø62x3,0	2	C75	Y03
24	a	231-1013	Disc spring 100/51x5,0 (4,7)	16	50CrV4	N15
25	a	250-0103	Screw M10x50 6K DIN 931	11	8.8	08.8
26	a	251-0107	Screw M8x35 C-I6 DIN 912	8	8.8	08.8
27	a	251-1054	Screw M5x12 C-I6 DIN 912	3	A2/70	7A2
28	a	251-7134	Pin screw M10x30 DIN 916	8	A2/70	7A2



DANFOSS
SYSTEM
HYDRAULIK A/S

PARTS-, SPARE PARTS, & MATERIAL LIST

COMPONENT: TYPE & VERSION

BRCF 012 - B1

SHEET: 2 OF: 2

PSM NO. 160N4008

ITEM Nos. or capital letters	REF.	ID NO.	CTM no. refers to DSH sheets: COMPARISON TABLES for MATERIALS			CTM NO.
			PARTS DESCRIPTION	QTY	MATERIAL	
29	a	266-0006	Locking disc M8 DIN 6798	8	C15	
30	a	208-0053	Copper disc $\phi 17/\phi 22 \times 1,5$	1	Copper	L02
31	a		Name plate	1	Stainless	F90
32	a	260-0412	Pin $\phi 1,9 \times 5$	4	Stainless	8A4
35	a		Glydring $\phi 102/\phi 86,5 \times 6,3$	1	Turcite 46	PF3
200	a	230-0044	Adhesive open/shut sign plate	1	Stainless	5A2
		160N4257	<u>Seal set BRCF 012 - B1</u> Consisting of item 13-14- 15-16-18-19-20-35.			

LUBRICATED WITH MOLYCOTE

TORQUE 25 Nm
(OILED)

TO RETAIN POS 23 USE ONLY MOLYCOTE

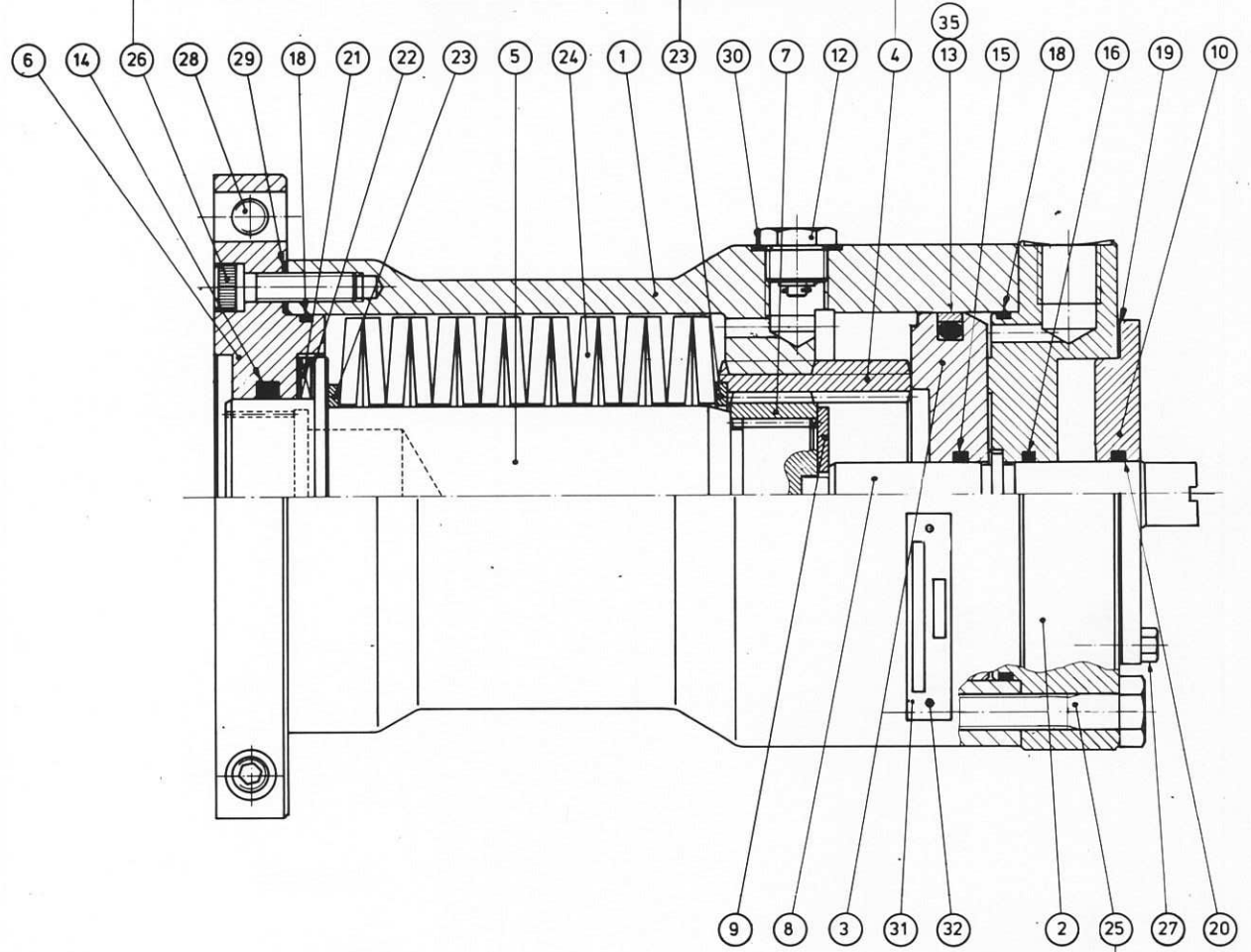
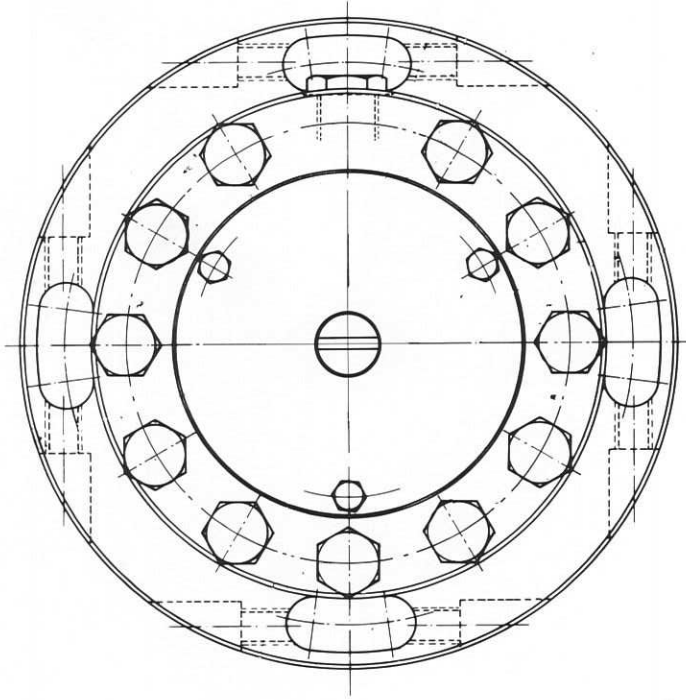

TORQUE 49 Nm
(OILED)

Before mounting of the piston pos.3 approx. 0.2 l gear oil must be poured over the splined member pos.4.

A special tool must be used for establishing the right position of the indicator mark on the indicator shaft pos.8 as shown on the drawing.

N		ID NO	MATR. DESIGNATION/DIM	NUMBER	UNIT	MATERIAL SURFACE TREATMENT	WEIGHT												
<p>SURFACES WITH NO R_a -</p> <p>FOR DIMENSIONS WITHOUT A TOLERANCE INDICATION</p> <table border="1"> <tr> <th>NUMERICAL DIM OVER TO</th> <th>TOLERANCE ISO 2768</th> </tr> <tr> <td>0.5 - 8</td> <td>0.1</td> </tr> <tr> <td>8 - 30</td> <td>0.2</td> </tr> <tr> <td>30 - 100</td> <td>0.3</td> </tr> <tr> <td>100 - 315</td> <td>0.5</td> </tr> <tr> <td>315 - 1000</td> <td>0.8</td> </tr> </table>								NUMERICAL DIM OVER TO	TOLERANCE ISO 2768	0.5 - 8	0.1	8 - 30	0.2	30 - 100	0.3	100 - 315	0.5	315 - 1000	0.8
NUMERICAL DIM OVER TO	TOLERANCE ISO 2768																		
0.5 - 8	0.1																		
8 - 30	0.2																		
30 - 100	0.3																		
100 - 315	0.5																		
315 - 1000	0.8																		
<p>DIMENSIONS IN MILLIMETRES UNLESS OTHERWISE STATED</p>		<p>FIRST ANGLE PROJECTION (ISO METHOD)</p>		<p>ALTR</p>	<p>DATE</p>	<p>BY</p>	<p>CHECK</p>												
<p>REPLACED BY</p>		<p>SCALE 1:1</p>		<p>900539 SV</p>															
<p>Danfoss</p> <p>DANFOSS SYSTEM HYDRAULIK A/S</p>		<p>ID NO</p> <p>TOTAL WEIGHT</p>		<p>ASSEMBLY DRAWING BRCF 012.</p>															
<p>DATE NO</p>		<p>760N9201</p>		<p>178-1108</p>															