

LUBRICATED WITH MOLYCOTE

TORQUE 25 Nm
(OILED)

TO RETAIN POS.23 USE ONLY MOLYCOTE

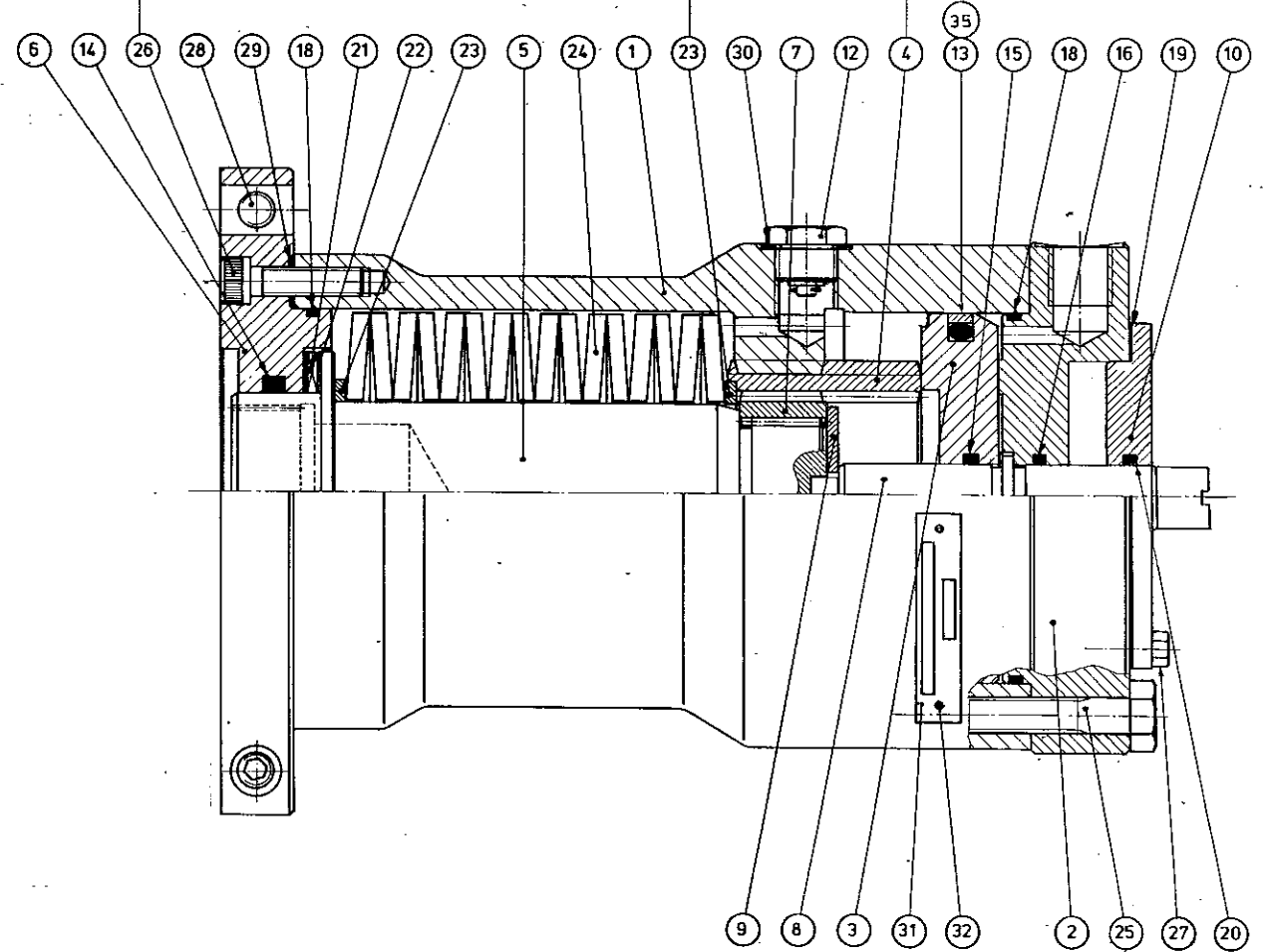
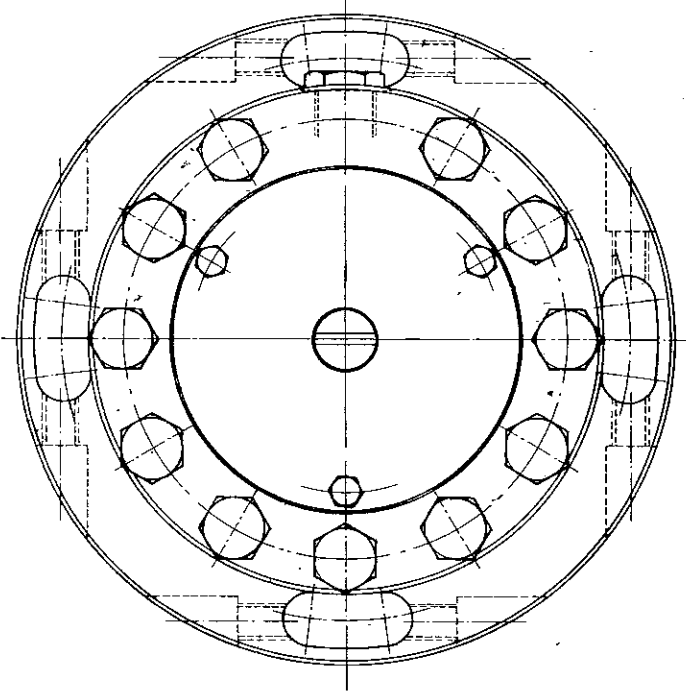

9 8 3 31 32 2 25 27 20

TORQUE 49 Nm
(OILED)

Before mounting of the piston pos.3 approx. 0.2 l gear oil must be poured over the splined member pos.4.

A special tool must be used for establishing the right position of the indicator mark on the indicator shaft pos.8 as shown on the drawing.

N	ID-NO.	MATH. DESIGNATION/IDM	NUMBER	UNIT	WGT. QUALITY/SUBSTANCE	WEIGHT
SURFACES WITH NO. 1 ROUGHNESS GRADE / $R_a =$		THIS PRINT IS PROVIDED ON A RESTRICTED BASIS. THIS PRINT IS TO BE RETURNED UPON REQUEST. IT IS TO BE USED ONLY FOR THE PURPOSE FOR WHICH IT WAS EXPRESSLY PRODUCED AND IS NOT TO BE COPIED IN ANY MANNER, NOR IS INFORMATION TAKEN THEREFROM TO BE TRANSMITTED OR PASSED ON TO OTHERS WITHOUT THE EXPRESSED PERMISSION OF DANFOSS SYSTEM HYDRAULIK.				
DIMENSIONS WITHOUT A TOLERANCE INDICATION		DIMENSIONS IN MILLIMETRES UNLESS OTHERWISE STATED				
NO-MIN. DIM. OVER TO	TOLERANCE ISO 2768	FIRST ANGLE PROJECTION ISO METHOD E		ALTR.	DATE	BY
0.5 - 3	± 0.1	SCALE 1:1			9/05/29	SV
3 - 30	± 0.2	TOTAL WEIGHT				
30 - 120	± 0.3					
120 - 315	± 0.5					
315 - 1000	± 0.8					
REPLACED BY		SCALE 1:1				
DESCRIPTION		TOTAL WEIGHT				
DANFOSS SYSTEM HYDRAULIK/AS		ASSEMBLY DRAWING BRCF 012.				
						160N9201