 DANFOSS SYSTEM HYDRAULIK A/S		PARTS-, SPARE PARTS, & MATERIAL LIST			
		COMPONENT: TYPE & VERSION	SHEET: 1	OF: 2	
		KFCM 22 - A1	160B0310	ISSUE	
			PSM.NO 033P156	x	
Notes: All items with stated ID nos. can be purchased as spare parts. When ordering spare parts – state ID no.			DATE	BY	CHECK
DRAWINGS REFERRED TO:					
DRAWING NO.	REF.	DESCRIPTION			
052B4811	a	Assembly drawing			
	b				
	c		921021	LSI	
	d		860908	LSI	OPE 3

ITEM Nos. or capital letters	REF.	ID NO.	PARTS DESCRIPTION	QTY	MATERIAL	CTM NO.	CTM no. refers to DSH sheets: COMPARISON TABLES for MATERIALS
1	a		Housing	1	GGG 40	A10	
2	a		Piston	1	GGG 40	A10	
3	a		Spindle	1	S-1802	F10	
4	a		Top part	1	SKF280	B54	
5	a		Spring guide	1	MS 58	L05	
6	a		Spindle f. man. operation	1	MS 58	L05	
7	a		Retainer	1	MS 58	L05	
8	a		Bushing	1	Esm. B	L50	
9	a		Stop bush	1	MS 58	L05	
10	a	045E4351	Clamping ring	1	S-1802	F10	
11	a	044-4561	Release lever unit	1			
			Compression spring	1	St. 60		
			Spring holder	1	Esm. B	L50	
			Locking ring	1	MS 58	L05	
			Pointed screw M4 x 4 DIN 916	1	70/A2	7A2	
			Crosshead DIN 6335	1	EL-Zn+		
13	a	034E1671	Hand lever shaft	2	AISI 304	F05	
15	a	007E9101	Compression spring	1	St.60		
16	a	033E6181	Screw-plug 3/8"RG	2	9SMnPb28	B10	
17	a		O-ring 54.5 x 3.0	1	NBR 70	NBR	
18	a		O-ring 56.87 x 1.78	1	NBR 70	NBR	
19	a		O-ring 27.3 x 2.4	1	NBR 70	NBR	
20	a		O-ring 24.6 x 2.4	1	NBR 70	NBR	
21	a		O-ring 19.5 x 3.0	3	NBR 70	NBR	
22	a		Scraper ø30/ø40-5/8	1	NBR 90		
23	a		Scraper ø20/ø28-7/4	1	NBR 90		
24	a	231-0576	Disc spring ø60/ø30.5 x 2.75	17	50CrV4	N15	
25	a		Thrust washer ø30/ø42 x 2.5	1	C-75		



**DANFOSS
SYSTEM
HYDRAULIK A/S**

PARTS-, SPARE PARTS, & MATERIAL LIST

COMPONENT: TYPE & VERSION

KFCM 22 - A1

SHEET: 2 OF: 2

160B0310

PSM.NO 033P1563

ITEM Nos. or capital letters	REF.	ID NO.	PARTS DESCRIPTION	QTY	MATERIAL	CTM NO.	CTM no. refers to DSH sheets: COMPARISON TABLES for MATERIALS
26	a		Thrust washer $\phi 12/\phi 18 \times 1.2$	2	C-75		
29	a		Pin $\phi 6 \times 50$ DIN 7	1	St.50K		
30	a		Cyl roller $\phi 4 \times 6$	1	100Cr6	ROL	
31	a	234-2022	Top cap $\phi 38 \times 32$	1	PVC		
32	a	234-0843	Knob f. handle $\phi 32 \times \phi 10$	2	Phenol		
33	a	033E8831	Crosshead DIN 6335	1	EL-Zn+		
34	a	250-2110	Screw M10 x 20, 6K DIN 933	4	8.8	08.8	
35	a	251-1583	Screw M6 x 20 C-I6K DIN 912	2	70/A4	7A4	
36	a		Pointed screw M5 x 5 DIN 916	1	70/A2	7A2	
37	a		Pointed screw M6 x 6 DIN 916	3	70/A2	7A2	
38	a		Pointed screw M4 x 4 DIN 916	1	70/A2	7A2	
39	a		Nut M10 DIN 934	1	50/A2	5A2	
40	a	208-0053	Washer $\phi 17/\phi 22 \times 1.5$	2	Copper DLP	L02	
41	a		Name plate 74 x 51 x 0.5	1	Stainless	F90	
42	a		Pin $\phi 1.9 \times 5$	4	50/A2	5A2	
43	a		X-ring 29.74/36.80 x 3.53	1	NBR 85	PD	
44	a		O-ring 11.6 x 2.4	1	NBR 70	NBR	
45	a		Cable ties 5 x 360	1	Nylon 6.6		
46	a	023-6771	Air escape valve	1			
			Housing	1	MS 58	L05	
			Cone spindle	1	MS 58	L05	
			Compression spring	1	St.60		
			Disc $\phi 5.3$ DIN 125	1	Steel		
			O-ring 5.1 x 1.6	1	NBR 70	NBR	
			Pin 1.5 x 15	1	Copper DLP	L02	
47	a	208-0053	Washer $\phi 17/\phi 22 \times 1.5$	1	Copper DLP	L02	
48	a		O-ring 19.6 x 2.4	1	NBR 70	NBR	
49	a		O-ring 60.08 x 1.78	1	NBR 70	NBR	
		219-0163	<u>Seal kit KFCM 22</u>				
			Consisting of:				
			Item 17-18-19-20-21-				
			22-23-43-44-48-49.				

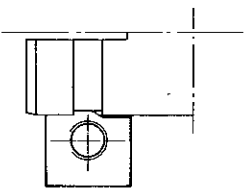
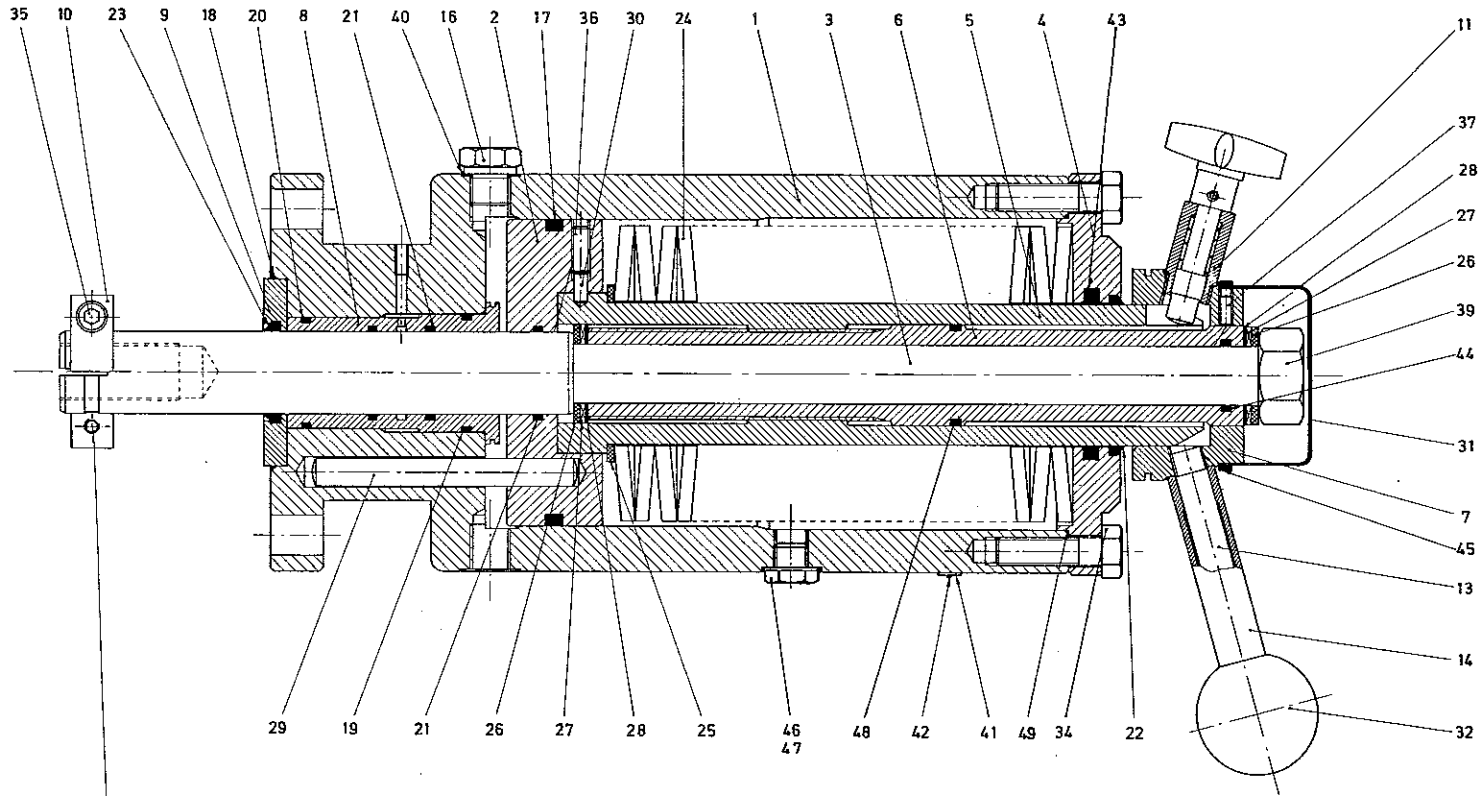

21

N		KFCM		A1/ 1052B4811							
<p>REVISIONS</p> <table border="1"> <tr> <th>NO.</th> <th>DATE</th> <th>DESCRIPTION</th> </tr> <tr> <td> </td> <td> </td> <td> </td> </tr> </table>						NO.	DATE	DESCRIPTION			
NO.	DATE	DESCRIPTION									
<p>DATE: 10/10/01</p> <p>BY: BERTHOLD</p> <p>CHECKED: BERTHOLD</p>											
<p>ASSEMBLY DRAWING</p> <p>KFCM</p>											