



# Bestobell

## Cryogenic Valves

### Constaflo

---

#### Birflo Range

---

DN6 - DN50 1/4" - 2"

---

#### Description

The CONSTAFLO is a simple water flow controller using a patented device that ensures the maintaining of flow rates with  $\pm 10\%$  of its rated capacity when operating within the limits of temperature and pressure specified in the 'Maximum Working Pressure' section.

---

#### Operation

A Neoprene diaphragm - working in conjunction with a profiled orifice - when subjected to pressure differences between 15 and 200psi (1.06 and 14kg/cm<sup>2</sup>) flexes on to the orifice to vary the orifice area, so maintaining a rate of flow irrespective of varying upstream or downstream pressures, within the operating range of the unit. An initial pressure drop of 15psi (1.06kg/cm<sup>2</sup>) is necessary before the unit reaches control point.

---

#### Maximum Working Pressure (MWP)

Max. Working Pressure: 200psi (14kg/cm<sup>2</sup>)

Max. Working Temperature: 65 °C

Min. Working Temperature : 1 °C

Max. Pressure Difference: 200psi (14kg/cm<sup>2</sup>)

Min. Pressure Difference: 15psi (1.06kg/cm<sup>2</sup>)

Accuracy  $\pm 10\%$  when operating in the range 15 to 200psi (1.06 to 14kg/cm<sup>2</sup>) pressure difference.

---

1/4" to 1/2"



3/4" to 2"



---

#### Technical

CE Marking according to Pressure Equipment Directive 97/23/EC.

π Marking to Directive 99/36/EC only on written request complete with purchase order.

For other options please contact us.



**Constaflo**

Birflo Range  
DN6 - DN50 1/4" - 2"

**Materials**

Body ( <i>marine</i> )	Gunmetal BS1400/LG2 - Kemtal
Orifice Plate ( <i>marine</i> )	Gunmetal BS1400/LG2 - Kemtal
Body ( <i>commercial</i> )	Gunmetal BS1400/LG2
Orifice Plate ( <i>commercial</i> )	Gunmetal BS1400/LG2
Diaphragm	EP6523 (or silicone - specified by customer)

Commercial	Version BSPT
Marine	Version BSPP

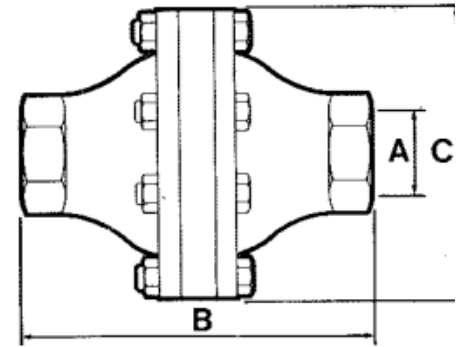

3/4" to 2"

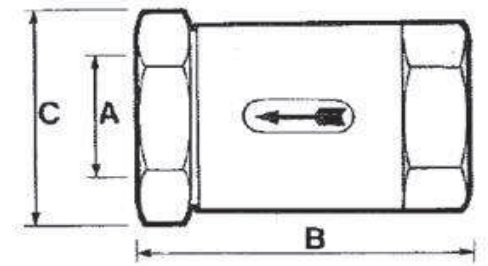

**Dimensional Details**

1/4" to 1/2"

Sizes 1/4" to 1/2"

Commercial	Marine	Size A	B	B	C	C
BSPT	BSP.PL	BSP.T & BSP.PL	in.	mm	in.	mm
112871	112881	1/4"	1 19/32	41	1 /32	26
112872	112882	3/8"	2 1/32	51	1 1/4	32
112873	112883	1/2"	2 3/32	53	1 15/32	37

Commercial Model	Marine Model	Size A BSPT & BSP.PL	B in.	B mm	C in.	C mm
BSPT	BSPP					
112874	112884	3/4"	3 17/32"	91	2 7/8"	73
112875	112885	1"	3 17/32"	91	2 7/8"	73
112876	112886	1 1/4"	6 3/16"	157	5 1/4"	133
112877	112887	1 1/2"	8 7/8"	225	7 3/8"	187
112878	112888	2"	10 5/8"	270	8 3/8"	213